

TRC

MAIN FEATURES

- ¹ Smallest size (10.2 × 18.2 × 14.8 mm) at 10A switching capacity relay for high density P.C. board mounting technique.
- ¹ 1A and 1C contact form available.
- ¹ Surge resistiveness of 5000V on series relays.
- ¹ Design conforms to foreign safety standard (UL/CSA/TUV).
- ¹ Selection of plastic insulation material for high temperature and better chemical solution performance.

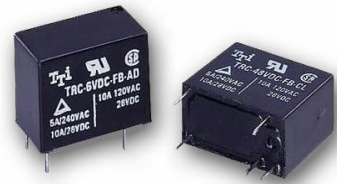

APPLICATIONS

- ¹ Domestic appliance, office machine, audio equipment, automobile, etc.

ORDERING INFORMATION

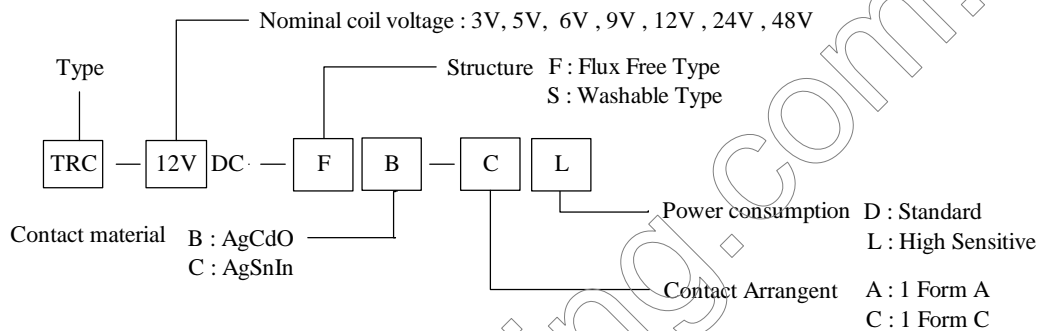

DIMENSION (unit:mm)

DRILLING (unit:mm)

WIRING DIAGRAM

1 Form A

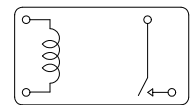
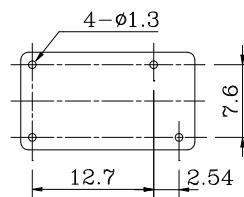
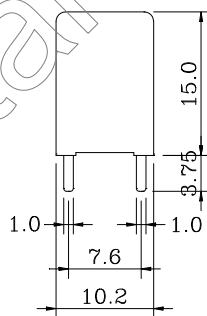
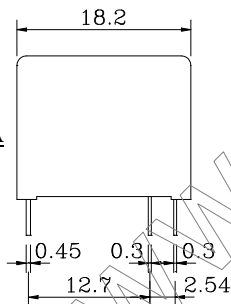

1 Form C

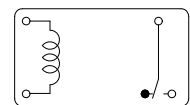
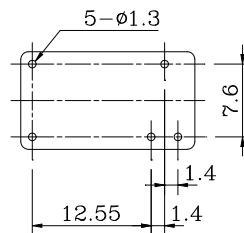
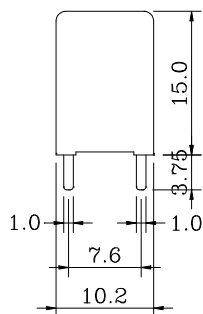
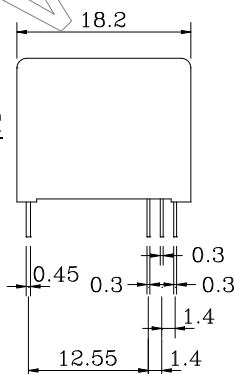

COIL DATA CHART (AT20^{1/4}C)

| Coil Sensitivity | Coil Voltage Code | Nominal Voltage (VDC) | Nominal Current (mA) | Coil Resistance (Ω) $\pm 10\%$ | Power Consumption (W) | Pull-In Voltage (VDC) | Drop-Out Voltage (VDC) | Max-Allowable Voltage (VDC) |
|-----------------------------|-------------------|-----------------------|----------------------|---|-----------------------|-----------------------|------------------------|-----------------------------|
| TRC-L (High Sensitivity) | 03 | 3 | 67 | 45 | abt. 0.2W | 75% Max. | 5% Min. | 130% Max. |
| | 05 | 5 | 40 | 125 | | | | |
| | 06 | 6 | 33.3 | 180 | | | | |
| | 09 | 9 | 22.5 | 400 | | | | |
| | 12 | 12 | 16.7 | 720 | | | | |
| | 24 | 24 | 8.16 | 2800 | | | | |
| TRC-D (Standard) | 03 | 3 | 150 | 20 | abt. 0.45W | 75% Max. | 5% Min. | 120% Max. |
| | 05 | 5 | 91 | 55 | | | | |
| | 06 | 6 | 75 | 80 | | | | |
| | 09 | 9 | 50 | 180 | | | | |
| | 12 | 12 | 37.5 | 320 | | | | |
| | 24 | 24 | 18.8 | 1280 | | | | |
| | 48 | 48 | 9.4 | 5100 | | | | |

CONTACT RATING

| Item | Type | TRC | |
|---|------|-------------------------|-----------------------|
| | | D Type | L Type |
| Contact Capacity | | | |
| Resistive Load ($\cos\Phi=1$) | | 10A 120VAC 10A 28VDC | 7A 120VAC 7A 28VDC |
| Inductive Load ($\cos\Phi=0.4$ L/R=7msec) | | 4A 120VAC 4A 28VDC | 2A 120VAC 2A 28VDC |
| Rated Carrying Current | | 10A | 7A |
| Max. Allowable Voltage | | 265VAC / 30VDC | |
| Max. Allowable Current | | 10A | 7A |
| Max. Allowable Power Force | | 1200VA / 280W | 840VA / 196W |
| Referenced Min. Applicable Load | | 5VDC / 10mA | |
| Contact Material | | Ag Alloy | |

REFERENCE DATA

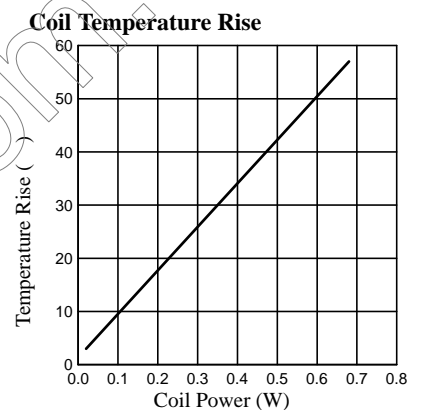

PERFORMANCE (at initial value)

| Item | Type | TRC | |
|---|------|--|--------------|
| | | 1 Form C | 1 Form A |
| Contact Resistance | | 100m Ω Max. | |
| Operation Time | | 10msec Max. | |
| Release Time | | 4msec Max. | |
| Dielectric Strength Between coil & contact Between contacts | | 2800VAC 1 minute 750VAC/min | 3500VAC 1min |
| Surge Resistiveness | | 5000V | |
| Insulation Resistance | | 100 M Ω Min. (500VDC) | |
| Max. ON/OFF Switching Mechanically Electrically | | 300 operation/min 30 operation/min | |
| Operating Ambient Temperature | | -30°C to +60°C | |
| Operating Humidity | | 45 to 85% RH | |
| Coil Temperature Rise | | 40 deg. Max. (at rated coil voltage) | |
| Vibration Endurance Error Operation | | 10 to 55HZ Double Amplitude 1.5mm 10 to 55HZ Double Amplitude 1.5mm | |
| Shock Endurance Error Operation | | 100G Min. 10G Min. | |
| Life Expectancy Mechanically Electrically | | 10 \times 10 ⁶ ops. Min. (no load) 10 \times 10 ⁴ ops. Min. (at rated coil voltage) | |
| Weight | | abt. 6grs. | |
| UL File No. | | E156521 | |
| CSA File No. | | LR102317 | |
| TUV File No. | | R9452084 | |

